

CO-ORDINATES LIST SYS#TM WGS31				
POINT	Y	Z	DESCRIPTION	
KP51	+90 180.347	+3 051 142.757	1299.956	CONTROL POINT
KP52	+90 175.457	+3 051 192.210	1299.611	CONTROL POINT
KP53	+90 223.355	+3 051 185.851	1298.622	CONTROL POINT
A	+90 232.068	+3 051 125.880	-	SERVICE BOUNDARY
B	+90 182.530	+3 051 123.126	-	SERVICE BOUNDARY
C	+90 165.610	+3 051 195.240	-	SERVICE BOUNDARY
D	+90 223.700	+3 051 201.590	-	SERVICE BOUNDARY
X1	+90 201.652	+3 051 131.317	-	SETTING OUT PEG
X2	+90 195.191	+3 051 185.447	-	SETTING OUT PEG
Y1	+90 213.853	+3 051 155.387	-	SETTING OUT PEG
Y2	+90 189.545	+3 051 152.695	-	SETTING OUT PEG
T4	+90 193.291	+3 051 204.285	-	HV TERMINAL
T1	+90 212.495	+3 051 135.778	1299.370	TERRACE LEVEL
T2	+90 195.084	+3 051 133.865	1299.633	TERRACE LEVEL
T3	+90 206.581	+3 051 186.880	1298.888	TERRACE LEVEL
T14	+90 185.337	+3 051 184.882	1299.458	TERRACE LEVEL
T15	+90204.703	+3 051 158.471	1299.160	TERRACE LEVEL
T16	+90224.918	+3 051 160.139	1299.005	TERRACE LEVEL
T17	+90227.692	+3 051 134.847	1299.215	TERRACE LEVEL
T18	+90212.560	+3 051 133.188	1299.370	TERRACE LEVEL
T19	+90214.665	+3 051 131.171	1299.620	TERRACE LEVEL
T10	+90203.890	+3 051 133.610	1299.620	TERRACE LEVEL
T11	+90285.905	+3 051 160.171	1299.585	TERRACE LEVEL
T12	+90291.456	+3 051 145.367	1299.585	TERRACE LEVEL
T13	+90283.448	+3 051 145.451	1299.750	TERRACE LEVEL
T14	+90281.902	+3 051 159.213	1299.750	TERRACE LEVEL
T15	+90288.809	+3 051 187.295	1299.423	TERRACE LEVEL
T16	+90283.982	+3 051 186.786	1299.463	TERRACE LEVEL
T17	+90285.414	+3 051 173.707	1299.530	TERRACE LEVEL
T18	+90290.518	+3 051 174.248	1299.603	TERRACE LEVEL
R1	+90 162.026	+3 051 176.624	1300.255	ROAD LEVEL
R2	+90 162.097	+3 051 179.392	1300.191	ROAD LEVEL
R3	+90 163.514	+3 051 183.105	1300.077	ROAD LEVEL
R4	+90 166.265	+3 051 185.972	1300.077	ROAD LEVEL
R5	+90 165.055	+3 051 187.322	1299.772	ROAD LEVEL
R6	+90 169.870	+3 051 192.595	1299.750	ROAD LEVEL
R7	+90 185.337	+3 051 189.268	1299.469	ROAD LEVEL
R8	+90 205.218	+3 051 191.440	1298.993	ROAD LEVEL
R9	+90 204.673	+3 051 196.410	1298.693	ROAD LEVEL
R10	+90 184.791	+3 051 194.242	1299.380	ROAD LEVEL
R11	+90 168.876	+3 051 192.486	1299.750	ROAD LEVEL
R12	+90 165.176	+3 051 192.790	1299.823	ROAD LEVEL
R13	+90 161.622	+3 051 194.566	1299.860	ROAD LEVEL
R14	+90 159.040	+3 051 197.586	1299.847	ROAD LEVEL
R15	+90 157.838	+3 051 201.373	1299.788	ROAD LEVEL
R16	+90 157.156	+3 051 204.153	1299.708	ROAD LEVEL
ROAD 1	+90 302.354	+3 050 703.904	-	ROAD RADIUS
ROAD 2	+90 301.795	+3 050 730.089	-	ROAD RADIUS

PROVIDE 150mm WEARING COURSE OF IMPORTED G4 MATERIAL COMPACTED TO 95% MOD AASHTO. SECOND LAYER

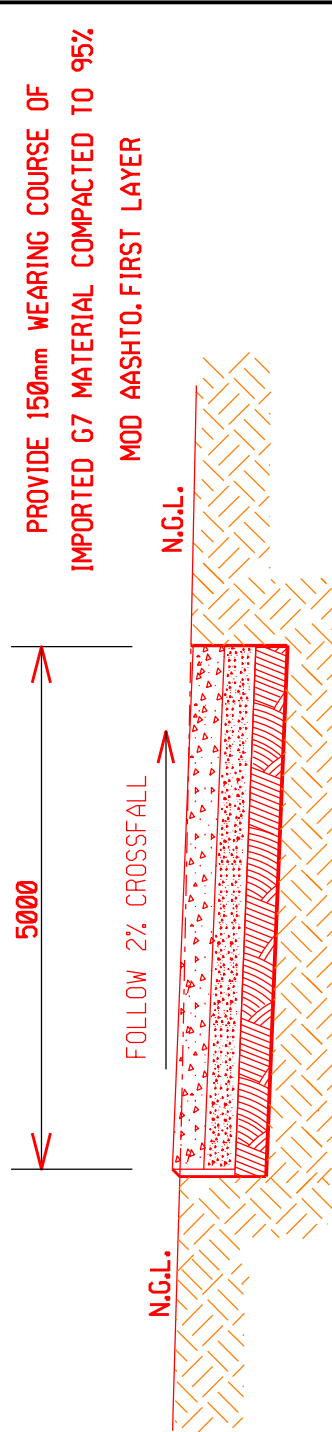

SCARIFY AND RECOMPACT 150mm SUBGRADE TO 93% OF MOD AASHTO DENSITY

LEVEL NOTES

1. ALL LEVELS SHOWN FOR TERRACE CORNER PGS ARE TOP OF TERRACE LEVELS (EXCLUDES YARDSTONE)
2. ALL LEVELS SHOWN FOR EDGE OF ROAD PGS ARE TOP OF G4 SURFACING IN ACCESS ROAD
3. TYPE A KERBS TO REMAIN OPEN AT 2m INTERVALS BETWEEN TL'S (3.5.6.7,11 & 12)
4. SIDES OF BANKS TO BE TOP-SOILED AND PLANTED WITH GRASS COVER ON COMPLETION AND ARE TO HAVE A MAXIMUM SLOPE OF 1:2

LEGEND

RL - ROAD LEVEL (FINISHED)
TL - TERRACE LEVEL

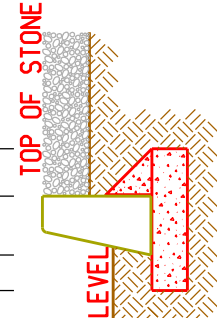

CONCRETE FILLET TO BE PLACED AT 150mm
ON BOTH SIDES OF ALL JOINTS
FOUNDATION CLASS 20MPa

EDGE OF STONE KERB DETAIL

					CHECKED	AUTHORIZED		KLIPSPRUIT SUBSTATION 88/22-kV SITE, LEVEL AND DRAINAGE PLAN	ER00045
					GVS <u>02/09/87</u> DRAWN	D.S.O. <u>12/09/87</u>			SET
					BILL <u>22/07/87</u>		Eskom Distribution		SHEET
					SCALE	1:300			REVISION
(0)	SA	Tk	PDC	1/02/81	NEW FEEDER BAY ADDED AND YARD EXTENDED				17
(8)	SN	Tk	PDC R&K	38/1/81	REDRAWN ON CAD, SUPERSEDES D-MN-32-BI-4H				Ø1
	REV			DATE	DESCRIPTION				Ø1